



SPARE PARTS EXPLODED VIEW  
STORAGE ELECTRIC WATER HEATERS  
Model  
**ABS ANDRIS LUX**

R8217264-03 - 13/05/2024

ABS ANDRIS LUX

Storage Electric Water Heaters

1	3100604	ABS ANDRIS LUX 10 OR	08-2015	-
2	3100605	ABS ANDRIS LUX 10 UR	08-2015	-
3	3100606	ABS ANDRIS LUX 15 OR	08-2015	-
4	3100607	ABS ANDRIS LUX 15 UR	08-2015	-
5	3100608	ABS ANDRIS LUX 30	08-2015	-
Col	Reference	Model type	Begin	End

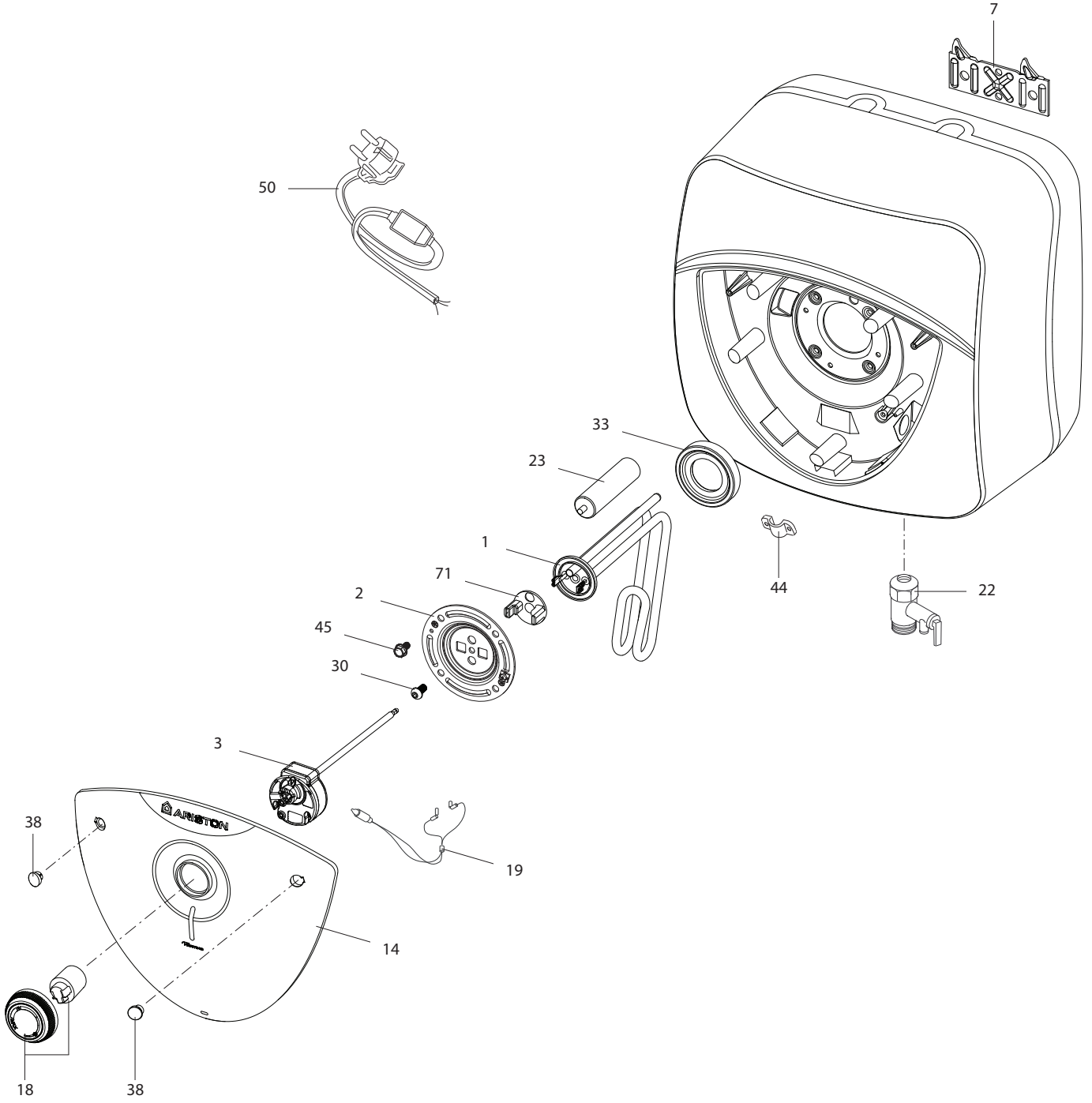

☉	Description	Manf. Pt. N	Type	<div style="display: flex; justify-content: space-between; align-items: center;"> <div style="writing-mode: vertical-rl; transform: rotate(180deg); font-size: 8px;"> A. ANDRIS LUX 10 OR  A. ANDRIS LUX 10 UR  A. ANDRIS LUX 15 OR  A. ANDRIS LUX 15 UR  A. ANDRIS LUX 30 </div> <div style="border: 1px solid black; padding: 2px; font-size: 10px;">31</div> </div>																		From	to
				1	2	3	4	5	6	7	8	9	10	11	12	13	14	15	16	17	18		
0001	HEATING ELEMENT 1200W 220-240V	65114900				•	•																
	HEATING ELEMENT 1200W 220-240V	65114905		•	•																		
	HEATING ELEMENT 1500W 220-240V	65114894								•													
0002	FLANGE (4 HOLES)	65114661		•	•	•	•	•													12/15		
	FLANGE (4 HOLES)	65115359		•	•	•	•	•												01/16			
0003	THERMOSTAT	65114891								•													
	THERMOSTAT	65114908		•																			
	THERMOSTAT	65115012			•																		
	THERMOSTAT	65115013				•																	
	THERMOSTAT	65115014						•															
0007	HEATER WALL HANGING BRACKET	570341		•	•	•	•	•															
0014	PLASTIC COVER (COMPLETE)	65115148								•													
	PLASTIC COVER (COMPLETE)	65115145		•	•	•	•	•															
0018	COMPLETE KNOB (REGULATION)	65115024		•	•	•	•	•															
0019	SIGNAL LAMP	65111550		•	•	•	•	•													05/24		
	SIGNAL LAMP	993025		•	•	•	•	•												06/24			
0022	SAFETY VALVE WITH LEVER (1/2" 8,5 BAR)	571730		•	•	•	•	•															
0023	ANODE D21,3 L:110 M5-M8	65103768-01		•	•	•	•	•															
0030	SCREW M6X12	993000		•	•	•	•	•															
0033	FLANGE GASKET	65116115		•	•	•	•	•															
0038	SCREW COVER	65115133		•	•	•	•	•															
0044	CABLE CLAMP	573266		•	•	•	•	•															
0045	FLANGE SCREW M6X12	65114656		•	•	•	•	•															
0050	POWER CABLE WITH ELCB (16 A 1,5m)	65151908		•	•	•	•	•															
0071	TERMINAL SHIELD (GREEN)	65121494								•													
	TERMINAL SHIELD (YELLOW)	65114901		•	•	•	•																

## LIST OF THE ABBREVIATIONS

HW .....	: Hot water.
CW .....	: Cold water.
C .....	: Ceramic resistance (normal heating).
Ca .....	: Ceramic resistance (accelerated heating)
TP .....	: Immersion heater.
1F .....	: With fittings.
2F .....	: Without fittings.
3F .....	: With fittings and another outlet connection.
AMI .....	: With mixing valve.
SMI .....	: Without mixing valve.
PUISS .....	: Power of th appliance.
PN .....	: Appliance with normal pression.
LP .....	: Appliance with low pression.
PV .....	: Appliance with variable power.
PF .....	: Appliance with fixed power.

## IDENTIFICATION PLATE

### SERIAL NUMBER

**6 Characters :**  
 Year of manufacture 03 09 08 Manufacturing day  
 Month of manufacture

**9 Characters :**  
 Year of manufacture 5 9 12 0606 Sequential number  
 Month of manufacture

**14 Characters :**  
 SI-V-0B0 45 07 0001  
 Sequential number  
 Year of manufacture : → 6 → 2004  
 Month of manufacture : → 25 → January 43 → July 7 → 2005  
 → 13 → February 29 → August 8 → 2006  
 → 32 → March 40 → September etc ...  
 → 35 → April 38 → October  
 → 39 → May 51 → November  
 → 45 → June 12 → December  
 Product model

**14 Characters :**  
 111518 XX 000010  
 Month of manufacture Sequential number  
 Day of manufacture Year of manufacture

**15 Characters :**  
 02 11 00001 007843  
 Year of manufacture Product reference  
 Month of manufacture Sequential number

**21 Characters :**  
 3200050 XX 08115 0000001  
 Product reference Sequential number  
 Year (08) / Manufacturing day (115)

**22 Characters :**  
 3200050 XX 070115 0000001  
 Product reference Sequential number  
 Year (07) / Month (01) / Manufacturing day (15)